

MEGALIFT COMPANY PROFILE



Lanxess Singapore Project (Year 2012) Reactor Column (80m x 6m x 5m – 248 ton)

Introduction



- **Megalift Company Profile**
- **Our Major Services**
 - **Airfreight**
 - **Seafreight**
 - **Customs Clearance & Transport**
 - **Warehouse & Distribution**
 - **Heavy Transport, Barging, Lifting and Erection**
- **Our Major Project Track Records**
- **Benefit of using Megalift**

Megalift Company Profile



- Year Established : 1980 (37 years)
- Staff Force : 350 personnel
- Branches : Penang, KLIA, Johor Bahru, Kuantan, Kota Kinabalu Sabah & Bintulu Sarawak
- Bumiputera Status : Registered with MOF, TNB, Petronas, KTM, Telekom)
- ISO 9001 accreditation
- Experienced in turnkey project forwarding both domestic and international

Major Facilities : 150 axle line goldhofer hydraulic multi-axle modular trailers (with dropdeck & selfpropel units), 8 pole trailers, 30 low bed trailers, 35 general trailers, 40 Hauliers, Tugboat & barge, mobile cranes, including 2 sets of 800 ton portable gantry system, jacking equipment & accessories



Penang Port
Penang Port

Lumut Port

Port Klang

Kuala Lumpur International Airport

TNB Track 3B Jimah Power Station 2100MW

Malaysia Rail Map

Lotte Titan Chemical Plant

Petraons RAPID

Kuantan Port

Pasir Gudang Port / Tanjung Langsung Port / PTP /
Senai / Tg Kupang / Tg Putri

Branch office at
Kota Kinabalu, Sabah
Megalift Sabah Sdn Bhd

Branch office at Bintulu, Sarawak
Megalift Bintulu Sdn Bhd

1) International Airfreight

- 30 staffs
- own office & warehouse at KLIA Cargo Terminal
- MAS Kargo Agent
- Consolidation service
- Worldwide Door to Door service
- Exclusive overseas project network
- Warehouse at KLIA for packing and labeling
- Cargo Marine insurance



2) International Seafreight

- 20 staffs
- LCL consolidations (Less Container Load)
- 20' & 40' FCL (Full Container Load)
- Charter Breakbulk Heavy Cargos Vessel
- Marine insurance
- Shipment Tracking



Experience Shipping Manager – Ms Kim



3) Customs Clearance, Port Handling and Inland Transport

- 90 staffs
- Customs Clearance (License : BF005)
- Port Handling
- Inland Transport
- Application of Import Permit / CIDB COA (Quality Testing)
- Application of Tax exemption from Ministry of Finance
- Application of COO / GSP / FTA / ATA Carnet



4) Warehouse & Distribution

- Covered Warehouse 31,051m² = 334,240 sq ft (7.6 acre)
- Opened Yard 16,187m² = 174,240 sq ft (4 acre)
- Stock Control Management
- Industrial Packing & Labelling
- Container stuffing, unstuffing, lashing & securing



Megalift Open Yard

Address : Lot 64283, Jalan Perigi Nenas 8/7, Taman Perindustrian Pualau Indah, 42920 Port Klang, Selangor,

Distance from Westport : 5 km Distance from Northport : 16 km

Total Land Area : 16,187 m² (4 acre) 174,240 sq ft



Megalift Covered Warehouse (Lot 4)

Address : Lot 4, Solok Sultan Hisamuddin 8, Kawasan 20, Selat Klang Utara, 42000 Port Klang, Selangor

Distance from Northport : 3 km Distance from Northport : 18 km

Total Land Area : 7,432 m² (1.8 acre) 80,000 sq ft



5) Heavy Transport

- 150 staffs
- Turnkey project logistics management
- Heavy transport
- Heavy lifting & installation & erection
- Barging



Megalift Equipment List

- (1) 150 axle Goldhofer hydraulic multi-axle modular trailers with self propel units and drop decks
- (2) Pole trailers 8 units
- (3) Low bed trailers 30 units
- (4) 40' General trailers 35 units
- (5) Container Haulier 40 units
- (6) Barge & Tug Boat (RORO)
- (7) 800 ton Megalift Portable Gantry Crane / StrandJack System
- (8) Crawler / Mobile cranes and Forklifts
- (9) Other Equipment & Accessories
 - RORO ramp / ballasting pump / wire rope / steel plate / cross beam / steel support / concrete block / winches / welding set / generators / air compressor / Hydraulic jack & skate roller – 10-30-60-100 ton, etc

150 axle Goldhofer Multi-Axle Hydraulic Trailers with SPT unit / drop deck / turntable system



Megalift Pole Trailer & Low Loader (2 axle to 7 axle < 50ton) 38 units



Container Haulier (with side loader) 40 units subsidiary company : Multi-Trans



Barge, beam & supports, ballasting pump



Megalift Gantry, Strand Jack

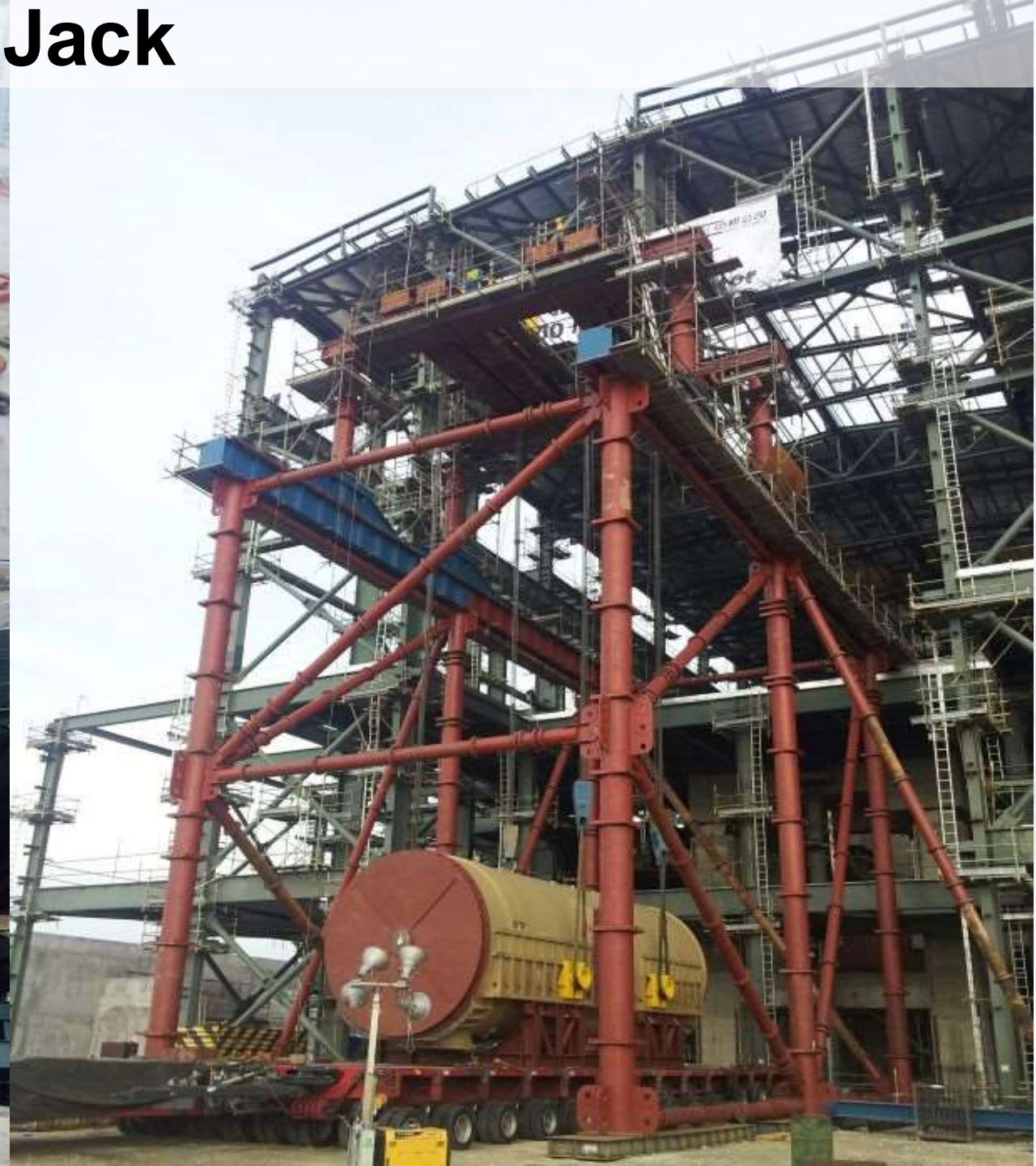

Megalift Dragon Jacking & Skidding System



Transformer – 2 x 270 ton + 2 x 127 ton

Mobile Crane & Crawler Crane



Megalift Track in Oil & Gas Refinery Project



Megalift Major Project Track Records – Oil & Gas

- **Petronas MG3 (Larson & Toubro) 2006**
- **Alcan Gove 3rd Stage Expansion G3 Project 2006**
- **Titan Butadiene & Propylene Project (CTCI) 2007**
- **Shell Hijau Project, Port Dickson (Fluor Daniel) 2011**
- **Chevron Gorgan Project / Saipen Leighton / Muhibbah Engineering 2012**
- **Petronas SOGT (Samsung Engineering) 2012**
- **Balai Cluster / Anjung Kecil / Kayu Manis Loudout (Dialog) 2013**
- **Petronas RAPID Deep Water Terminal (Dialog) 2013**
- **Chevron Gorgan Project (John Zink) 2014**
- **Technip D18 Project 2015**
- **Petronas RAPID (Toyo Engineering) 2015**
- **Lotte Titan Chemical Project (GS Engineering) 2016**

Lotte Chemical TE3 PROJECT (GS Engineering) Year 2016, Sept 5th
Propylene Splitter 94m x 5.78m x 5.05m – 580 ton



Petronas RAPID PROJECT (TOYO) MOLF Tanjung Setapa Port (Year 2016)



GREATER D18 PROJECT (TECHNIP) (Year 2015 Oct)

Heavy Lifting Reel

– 5m x 9.6m x 9.6m – 352 ton
(InterMarine Heavylift Vessel)



SHELL HIJAU Project (Flour) (Year 2011)

Reactor (21m x 6m x 6.4m – 214 ton)

Erection 650t Monitowoc CC18000



Lanxess Singapore Project (Year 2012)

Reactor Column (80m x 6m x 5m – 248 ton)



LINDE ENGINEERING (Year 2010) Cold Box (39m x 4.4m x 3.6m – 85T)



NORTHPORT IMPSA Quay Crane – 1200 ton



Port of Tanjung Pelepas IMPSA Quay Crane – 1200 ton



**Penang Port Quay Crane – 80m x 26m x 54m
– 730 ton (Year 2013)**



Port of Tanjung Pelepas IMPSA Quay Crane – 1200 ton



Megalift Track in Power Energy Project



Megalift Major Project Track Records – Power Energy

- **Genting Highlands Power Plant** - 1981/2 - BBC Brown Boveri
- **Temengor Hydro Electric Power Station** - 1982 - Sprecher & Schuh
- **Paka Power Station** - 1982/5 - Mitsui Alstom/EGT/Stein Industries
- **Batang Ai Hydro Electric Power Station** - 1983/4 - Mitsui/Toshiba
- **Temenggor/ Tanah Merah Transmission Line** - 1985 - Fujikura
- **Connaught Bridge Power Station** - 1989/90 - CMI/ABB Lummus
- **Sungai Piah Hydro Electric Power Station** - 1990 - Bharat
- **Kapar Power Station** - 1993 - GEC Alstom/EGT
- **Melaka Power Station** - 1996 - GE Power
- **Pergau Hydro Electric Power Station** - 1993/4 - GEC Alstom
- **Pergau Hydro Electric Power Station** - 1993/4 - Kerjaya Balfour Beatty
- **YTL – Pasir Gudang Power Station** - 1994/5 - Siemens/Babcock
- **YTL – Paka Power Station** - 1994/5 - Siemens/Babcock
- **Genting Sanyen Kuala Langat Power Station** - 1995 - ABB
- **Malakoff – Segari Power Station** - 1995/6 - ABB
- **Kapar Power Station** - 1995/6 - IHI
- **Paka Power Station** - 1995/6 - Ansaldo/Daelim
- **Sutra – Sutra Harbour Power Station,** - 1997 - NKK/Kota Kinabalu
- **Pahang Cement Cogenerating Plant** - 1997 - Siemens
- **MNI – Congenerating Plant, Temerloh** - 1998 - ABB
- **Tg. Kidurong Power Station, Bintulu** - 1998 - GEC Alstom

Megalift Major Project Track Records – Power Energy (continue)

- **Janamanjung Power Station (2100MW Coal Fired) - 2000/3 - Alstom, UK**
- **Malakoff – GB3 Power Plant (650MW CCPP) - 2001/2 - Alstom**
- **TTPC - Perlis Power Plant (650MW CCPP) - 2001/2 - Alstom**
- **Panglima Power Station (720MW CCPP) - 2001-2 - Siemens**
- **Prai Power Station (350MW CCPP) - 2002 - Toshiba**
- **Gelugor Power Station - 2002 - KHI**
- **Cameron Highland Hydro Plant - 2006/7 - Voith Siemens**
- **Tanjung Bin Power Station (2100MW Coal Fired) - 2004/7 - Sumitomo / IHI / Toshiba**
- **Jimah Power Station (1400MW Coal Fired) - 2006/8 - Sumitomo / IHI / Toshiba**
- **Kina Biopower & Seguntor Biopower, Sabah - 2007 - Maidensha**
- **Bakun Power Station (8x300MW) - 2010 - IMPSA**
- **Sarawak Samalaju Substation - 2011 - Siemens**
- **MANJUNG 4 Power Station (1000 MW Coal Fired) - 2011/4 - Alstom / CMC**
- **Kimanis Power Station - 2012/3 - CTCI**
- **Sarawak Lachu Substation - 2013 - Alstom Grid**
- **Ulu Trengganu Hydro Power Station - 2013/4 - Alstom**
- **Tanjung Bin 4 Power Station (1000MW Coal Fired) - 2013/5 - Alstom**

Megalift Major Project Track Records – Power Energy (continue)

- **Prai Power Station (1400MW CCPP)** - 2013/5 - **Samsung C&T**
- **Manjung 5 Power Station (1000MW Coal Fired)** - 2014/6 - **Sumitomo / Daelim**
- **Sarawak Samalaju Extension Substation** - 2015 - **Siemens**
- **TNB Jimah East Power (2000MW Coal Fired)** - 2016 - **IHI / Toshiba**

- **Many heavy transformers for TNB substations/contractors/manufacturers in Malaysia)**
- **IPP & TNB Maintenance Contract / Outages)**

OVERSEAS POWER STATION PROJECTS

- **Paiton Power Station, Indonesia** - 1998 - **Japanese Consortium**
- **Guan Power Station, USA** - 1998 - **Mitsui**
- **3 power station in Taiwan** - 2002 - **Toshiba**
- **Amata Power Station, Thailand (Major Outage)** - 2003/4/6 - **Siemens**
- **Phu My Power Station, Vietnam (Major Outage)** - 2003/4/6 - **Siemens**
- **Maura Tawar Power Station, Indonesia** - 2004 - **Siemens**
- **Songkla Power Station , Thailand** - 2007 - **Siemens**
- **Shauiq Power Station, Saudi Arabia** - 2009/10 - **Mitsubishi Heavy Industries**
- **Glow Phase 5 Combined Cycle / Cogen Power Station, Thailand – 2010** - **Marubeni**

Prai 1400MW CCPP (Samsung C&T) (Year 2014)

Gas Turbine – 14m x 5.5m x 5.8m – 450 ton



Tanjung Bin 4 - 1000MW Coal Fired Power Station (Alstom) (Year 2014)

Generator Stator – 450 ton



Manjung 4 – 1000 MW Coal Fired Power Station (Alstom) (Year 2013) Generator Stator – 12.8m x 4.9m x 4.6 - 465 ton



Manjung 4 – 1000 MW Coal Fired Power Station (Alstom) (Year 2013)

Generator Stator – 12.8m x 4.9m x 4.6 - 465 ton



MEGALIFT TRACK RECORD IN CONSTRUCTION PROJECT



Megalift Major Track Records – Railway / Infrastructure / Plants

(A) KTM / PRASARANA / MRT / LRT RAILWAY PROJECT

- ERL Project (YTL) - Year 2000
- KTM Rawang to Ipoh Northern Double Track Project (Emrail & Balfour Beatty) - Year 2004
- KTM Rehabilitation - Ipoh to Butterworth (IRCON) - Year 2006
- Relocate Rails equipment (Emrail-Leighton) - Year 2007
- KTM Sentul to Batu Caves Double Track Project (YTL) - Year 2008
- YTL Padang Rengas Railway Project (YTL) - Year 2008
- KTM Ipoh to Padang Besar Double Track Project (MMC Gamuda) - Year 2008/12
- LRT Kelana Jaya Line Extension Project (Colas Rail) - Year 2013
- LRT Ampang Line Extension Project (CHEC Rail) - Year 2013
- KVMRT (Herrenkencht 8 TBM + CREC 2 TBM) - Year 2013/14
- KVMRT (MHI Rails) - Year 2014/15
- KVMRT (Siemens Electric Train + Depot Equipment) - Year 2014/16
- KTM Klang Valley Double Track Project – Rawang to Salak South (DMIA) - Year 2016
- KTM Rehabilitation – Gemas to Tumpat, Kelantan (Fajar Baru / Hikmat Asia) - Year 2016

Megalift Major Track Records – Railway / Infrastructure / Plants

(B) HIGHWAY / BRIDGE / SEWAGE PROJECT

- Ampang-KL Elevated Highway (Percon-Leighton) - Year 2000/01
- BR-8 Bridge Putrajaya (Road Builder) - Year 2001
- Inner Link Raod Prai Project (IJM) - Year 2004/05
- JPP Sewage Water Treatment Plant Phase 1 : Package 1 (Hitachi) - Year 2005/06
- JPP Sewage Water Treatment Plant Phase 2 : Package 3 (Ebara/Nishiara) - Year 2007
- JPP Sewage Water Treatment Plant Phase 2 : Package 2 (Taisei/Kubota) - Year 2008/09
- SMART Tunnelling Project (Gamuda / Herrenknecht) - Year 2006/07
- Teriang Water Transfer Project (Zecon / Ultra Construction) - Year 2007
- Penang Bridge Extension Project (UEM / CHEC) - Year 2008
- Pahang Selangor Water Transfer Project (Shimtizu/Robins) - Year 2013/14

Megalift Major Track Records – Railway / Highway Infrastructure / Plants

(C) PLANT PROJECT

- Kuantan Mentakab - Malaysian Newsprint Industries Plant - Year 1998
- Kuantan Gebeng, Mico Chipboard Plant - Year 2004
- Langkawi Larfage Grinding Mills Plant (Relocation Langkawi to Rawang) - Year 2004
- PT Domba Mas, Ole Chemical Plant - Year 2004
- Mewah Oil Plant (Relocation from Semiyeh to Westport) - Year 2004
- Sarawak Bintulu - Tokuyama Plant - Year 2012
- Negeri Sembilan - Bahau Cement Plant (Sinoma) - Year 2012/13
- Lumut Vale Malaysia Minerals Plant (Dalian Heavy Industry) - Year 2013
- YTL Perak Hanjoong Project (KHD / Avic) - Year 2013
- YTL Perak Hanjoong – Water Heat Recovery Project (Sinoma) - Year 2013
- YTL Strait Cement Project (KHD / Avic) - Year 2013/14
- Melaka XINYI Solar Plant - Year 2016
- Kuantan Alliance Steel Plant (350,000 ton Production Capacity) - Year 2016

KVMRT (Siemens) (Year 2014) 232 Electric Trains + Depot Equipment



KVMRT TBM (Herrenknecht) (Year 2013) 8 sets Tunnel Boring Machine



KVMRT TBM (China Railway) (Year 2013) 2 sets Tunnel Boring Machine

(Year 2013) 2 sets Tunnel Boring Machine



LAFARGE CEMENT PLANT – 280 ton Grinding Mills



WHY Megalift :-

1) Large fleet of Trailers & Equipment



2) Strong Technical Team - 8 Engineer + 2 Autocad Draftmen

Cargo Drawing

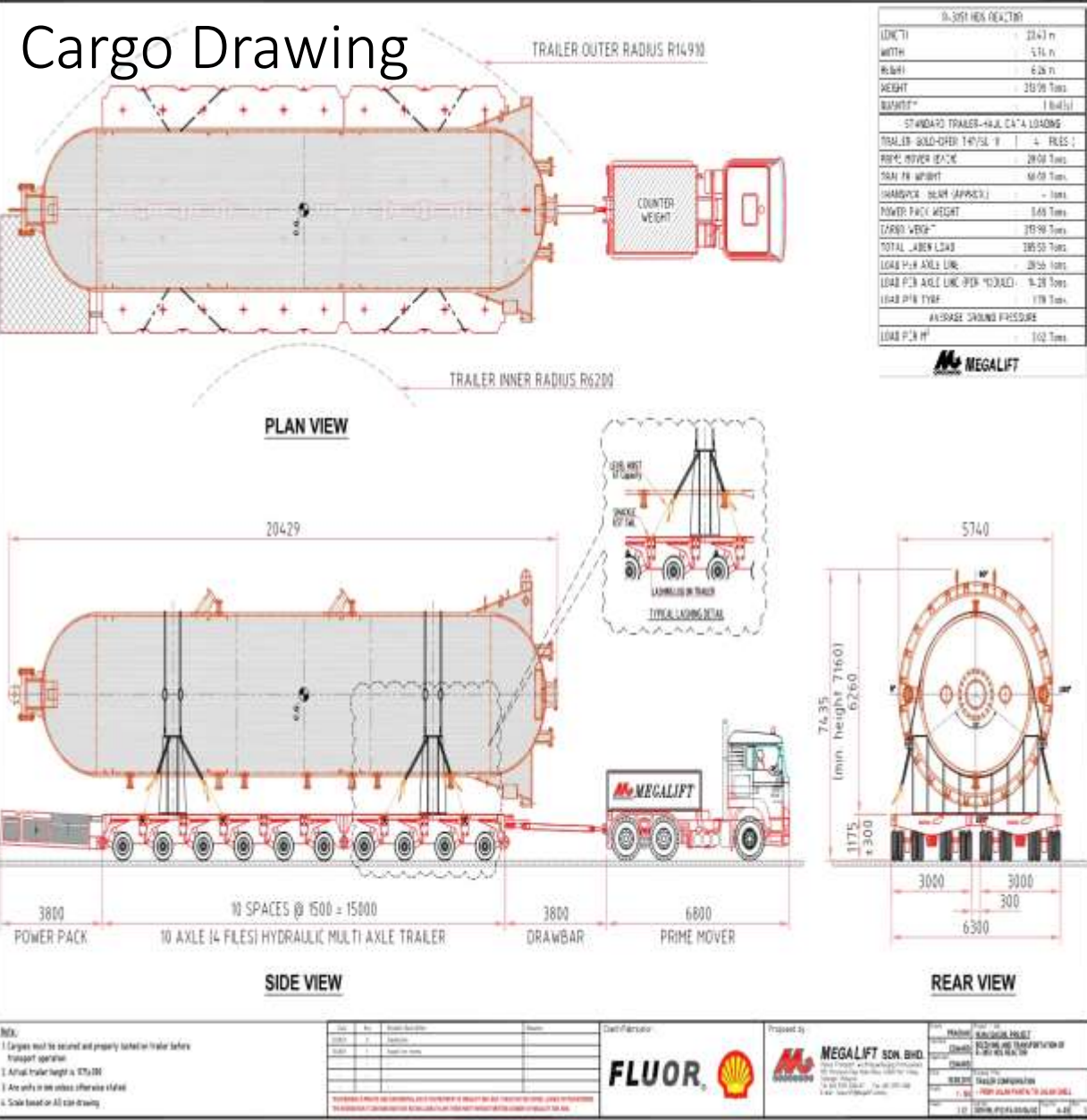

Erection Plan

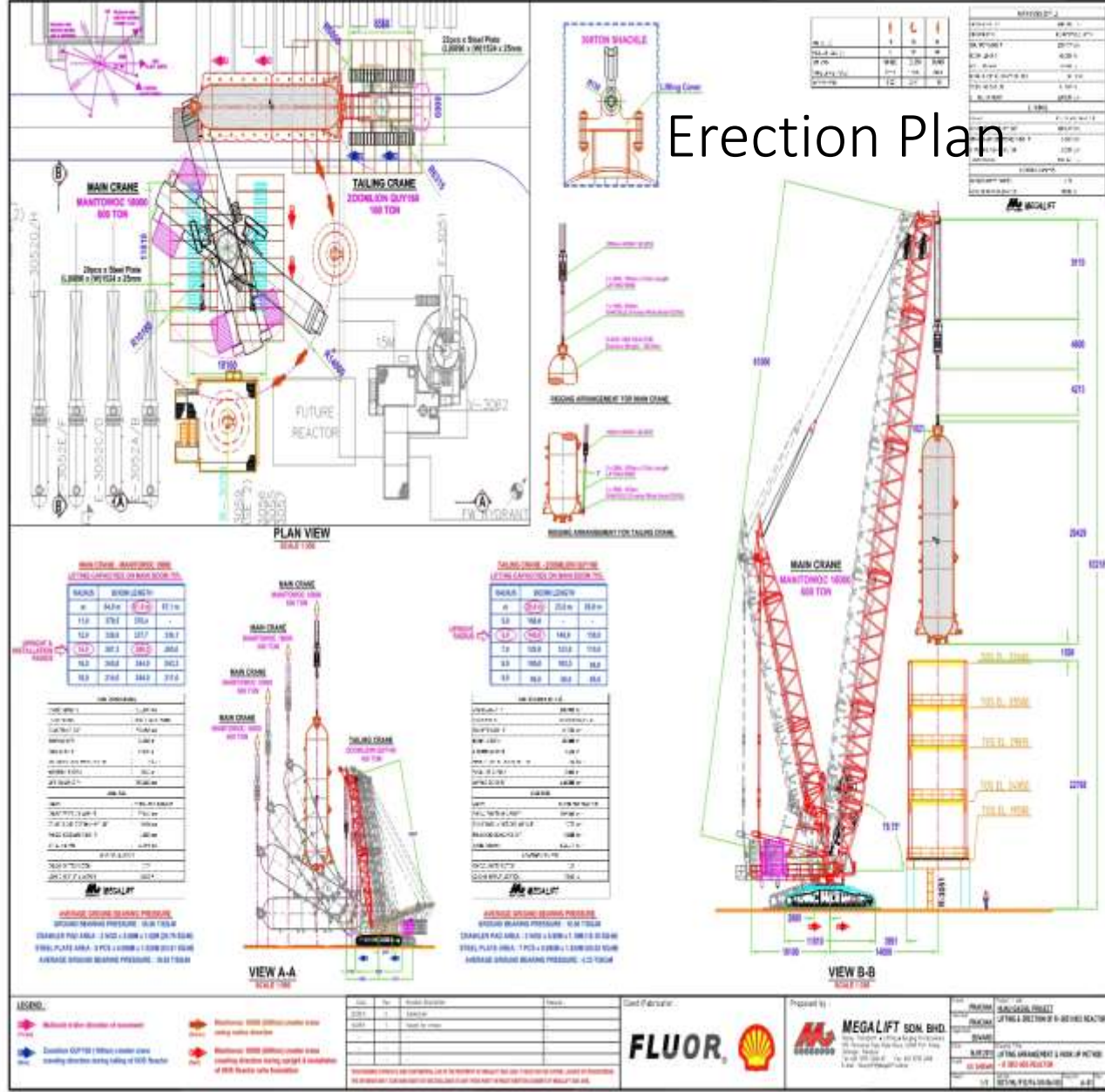

Turning Stimulation Report



Date	Rev	Revision Description	Remarks	Client / Fabricators	Proposed by:	Drawn	Project / Job	
-	-	-	-		 Heavy Transport • Lifting • Rigging Professionals 88, Persiaran Raja Muda Musa, 43000 Port Klang, Selangor, Malaysia Tel: +60 3 975 228-47 Fax: +60 3 975 2288 E-mail: megalift@megalift.com.my	RD4	JOHNS 3 POWER PLANT	
-	-	-	-			REVIN	PROPOSED TURNING RADII FOR TRAILER	
-	-	-	-			DEMON		
-	-	-	-			DATE	02/10/2014	
-	-	-	-			SCALE	1:30	
THIS DRAWING IS PRIVATE AND CONFIDENTIAL AND IS THE PROPERTY OF MEGALIFT SDN BHD. IT MUST NOT BE COPIED, LOANED OR TRANSMITTED. THE INFORMATION IT CONTAINS MUST NOT BE DISCLOSED TO ANY THIRD PARTY WITHOUT WRITTEN CONSENT OF MEGALIFT SDN BHD.				Sheet	1/4	2245-ML/199/F4/0101038	Rev	A-01

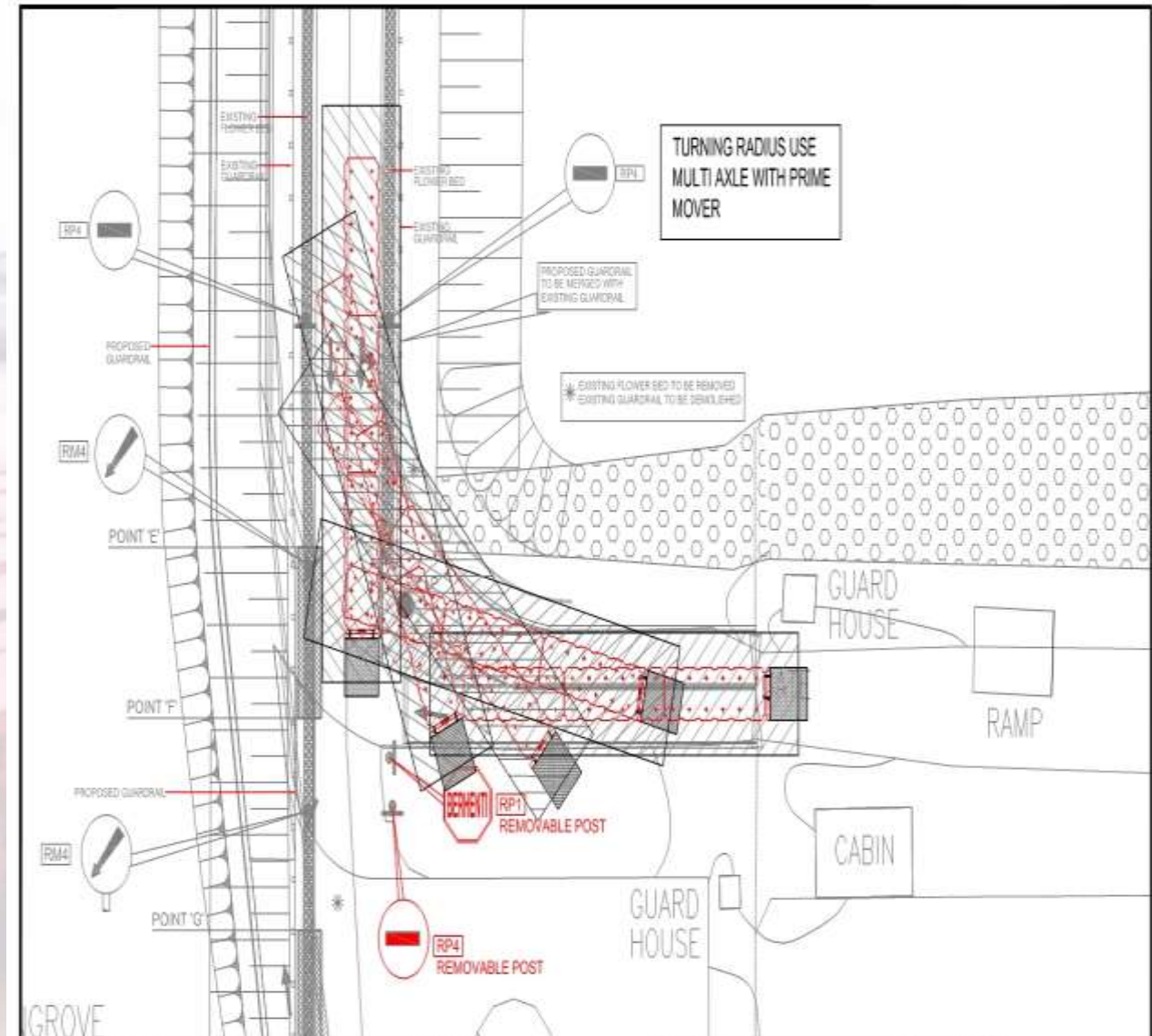

Date	Rev	Revision Description	Remarks	Client / Fabricators	Proposed by:	Drawn	Project / Job	
-	-	-	-		 Heavy Transport • Lifting • Rigging Professionals 88, Persiaran Raja Muda Musa, 43000 Port Klang, Selangor, Malaysia Tel: +60 3 975 228-47 Fax: +60 3 975 2288 E-mail: megalift@megalift.com.my	RD4	JOHNS 3 POWER PLANT	
-	-	-	-			REVIN	PROPOSED TURNING RADII FOR TRAILER	
-	-	-	-			DEMON		
-	-	-	-			DATE	02/10/2014	
-	-	-	-			SCALE	1:30	
THIS DRAWING IS PRIVATE AND CONFIDENTIAL AND IS THE PROPERTY OF MEGALIFT SDN BHD. IT MUST NOT BE COPIED, LOANED OR TRANSMITTED. THE INFORMATION IT CONTAINS MUST NOT BE DISCLOSED TO ANY THIRD PARTY WITHOUT WRITTEN CONSENT OF MEGALIFT SDN BHD.				Sheet	1/4	2245-ML/199/F4/0101038	Rev	A-01

Bridge Static Report

<u>Trailer Cargo</u>	<u>Number of Axle</u>	<u>Weight (Ton)</u>	<u>Comments</u>
IP Turbine	14	201	Bridge Beam will be subjected to tension but no crack yet if the trailer is guided along the bridge.
Feed Water Tank 1/2	16	228	Bridge Beam will be subjected to tension but no crack yet if the trailer is guided along the bridge.
Feed Water Tank 2/2	12	170	Bridge Beam will be subjected to tension but no crack yet if the trailer is guided along the bridge.
HP Heater	11	146	Bridge Beam will be subjected to tension but no crack yet if the trailer is guided along the bridge.
Cond Module	12	192	Bridge Beam will be subjected to tension but no crack yet if the trailer is guided along the bridge.
Neck	12	152	Bridge Beam will be subjected to tension but no crack yet if the trailer is guided along the bridge.
Connecting Piece	12	142	OK
Hotwell	12	122	OK
Generator Stator	12	572	Bridge Beam will be subjected to crack width up to 0.2mm even through the trailer is guided along the bridge.

Jetty Static Report

8. SUMMARY

From the jetty analysis, it can be concluded that the jetty is marginally pass the design check based on the weight of trailer with generator. The jetty calculations show that concrete crosshead beam type 2 may experience cracks of up to 0.326mm during the transportation that may close up back after the load is removed.

The results of jetty elements check are summarised as below:

Structure Elements	Max Bending Moment, ULS (kNm)		Existing Reinforcement* (mm ²)		Required Reinforcement (mm ²)	Crack Width (mm)	Status
	Hogging	Sagging	Top	Bottom			
Crosshead Beam Type 1&3	Hogging	417	Top	9T25 (4418)	1658	0.132	Passed
	Sagging	1145	Bottom	9T32 (7238)	4643	0.292	Passed
# Crosshead Beam Type 2	Hogging	242	Top	7T32 (5630)	1170	0.053	Passed
	Sagging	1667	Bottom	12T32 (9651)	7024	0.326	Passed but crack width >0.3mm
Slab	Hogging	175	Top	T16-150 (1327)	1203	0.121	Passed
	Sagging	200	Bottom	T32-150 (5308)	1406	0.270	Passed

* Note: The section capacity check was based on the reinforcing bar as read/assumed from the Existing Drawings given by Client.

3) Observe Safety Practice Inhouse 2 Safety Officer + 1 QA Manager



CERTIFICATION
INTERNATIONAL

Certificate of Registration

This is to certify that

Megalift Sdn Bhd

No. 199, Persiaran Raja Muda Musa, 42000 Port Klang, Selangor
D. E., Malaysia.

operates a quality management system which has been assessed as conforming to
ISO 9001:2008

for the scope of activities

**Provision of services for heavy transportation, lifting, installation
and barging.**

Certificate No: **CI/2598** Issue Date: **05 September 2013**

Valid until **04 September 2016** subject to adherence to the agreed ongoing audit programme, successful
endorsement of certification following each audit and compliance with CI Regulations.
Date of original issue: 05 September 2001

Signed for and on behalf of

Accreditation Manager



063



Certification International (UK) Ltd., Delta 200, Delta Business Park, Great Western Way, Swindon, Wiltshire, SN5 7XP, United Kingdom



PERAKUAN PENDAFTARAN

Adalah dengan ini diperakui bahawa kontraktor yang dinyatakan
di bawah ini telah berdaftar dengan Lembaga mengikut
Bahagian VI Akta Lembaga Pembangunan Industri Pembinaan Malaysia 1994.
Pendaftaran ini adalah tertakluk kepada syarat-syarat yang telah
ditetapkan di belakang Perakuan ini

No Pendaftaran: 0120110816-WP135805

Nama Kontraktor: MEGALIFT SDN. BHD.

Alamat Berdaftar: SUITE 7.21 & 7.22
7TH FLOOR, IMBI PLAZA
JALAN IMBI
65100 KUALA LUMPUR
WILAYAH PERSEKUTUAN

Geod, kategori dan pengkhususan berdaftar

G7 ME M15

Tarikh Mulai Berkuatkuasa: 07 MAY 2014

Tarikh Habis Tempoh Perakuan: 06 MAY 2016*

*Perakuan ini hendaklah diperbaharui sebelum tarikh berakhir 07 hari sebelum tarikh habis tempoh

STATUS : **AKTIF** - Kontraktor yang diawardskan projek semasa
perakuan pendaftaran ini dikeluarkan.

Sr MOHD ZAID ZAKARIA

h.p. Ketua Eksekutif

bertarikh: 07 MAY 2014



4) Best Track Record in Transport, Barging & RORO, Erection

Petronas Olefin (Samsung Engineering) (Year 1999)



**SHELL HIJAU Project (Flour) (Year 2011)
Reactor 214 ton - Erection 650t Manitowoc CC18000**



Manjung 4 Power Station – 465 ton Generator Stator



Port of Tanjung Pelepas IMPSA Quay Crane – 1200 ton



THANK YOU - we assure you of our best service & commitment at all time

1) Adrian Tan – CEO

Mobile : +60 (12) 3113128 adriantan@megalift.com.my



2) Lim Ling Ling – General Manager – Sales & Business Development

Mobile : +60 (12) 3113108 lingling@megalift.com.my



3) Nasrul Ramli –Senior Manager – Operations & Technical

Mobile : +60 (12) 3113329 nasrul@megalift.com.my



PRAI POWER STATION (Samsung C&T) Year 2014

Gas Turbine – 14m x 5.5m x 5.75m – 450 ton

